

BEFORE THE ILLINOIS POLLUTION CONTROL BOARD **RECEIVED**  
CLERK'S OFFICE

Quality Pork L.L.C.  
(Property Identification Number  
24-05-300-004)

)  
)  
)  
)  
)

04-41  
PCB 05-  
(Tax Certificate)

OCT 01 2003

STATE OF ILLINOIS  
Pollution Control Board

NOTICE

Dorothy M. Gunn, Clerk  
Illinois Pollution Control Board  
James R. Thompson Center  
100 West Randolph Street, Suite. 11-500  
Chicago, Illinois 60601

Kim Huntley  
5173 Bend Road  
Chana Illinois 61015

Steve Santarelli  
Illinois Department of Revenue  
101 West Jefferson  
Post Office Box 19033  
Springfield, Illinois 62794

PLEASE TAKE NOTICE that I have today filed with the Office of the Clerk of the  
Pollution Control Board an APPEARANCE AND THE RECOMMENDATION of the Illinois  
Environmental Protection Agency, a copy of which is herewith served upon you.

ILLINOIS ENVIRONMENTAL  
PROTECTION AGENCY

By: 

Lisa Moreno  
Assistant Counsel  
Division of Legal Counsel

DATED: September 29, 2003

Illinois Environmental Protection Agency  
1021 North Grand Avenue East  
Post Office Box 19276  
Springfield, Illinois 62794-9276  
(217) 782-5544

THIS FILING IS SUBMITTED ON RECYCLED PAPER

**RECEIVED**  
CLERK'S OFFICE

OCT 01 2003

**BEFORE THE ILLINOIS POLLUTION CONTROL BOARD**

STATE OF ILLINOIS  
Pollution Control Board

Quality Pork L.L.C.  
(Property Identification Number  
24-05-300-004)

)  
)  
)  
)

0441  
PCB ~~03~~  
(Tax Certification)

**APPEARANCE**

The undersigned, as one of its attorneys, hereby enters an APPEARANCE on behalf of  
Respondent, Illinois Environmental Protection Agency.

ILLINOIS ENVIRONMENTAL  
PROTECTION AGENCY

By: Lisa Moreno

Lisa Moreno  
Assistant Counsel  
Division of Legal Counsel

DATED: September 29, 2003

Illinois Environmental Protection Agency  
1021 North Grand Avenue East  
Post Office Box 19276  
Springfield, Illinois 62794-9276  
(217)782-5544

**THIS FILING IS SUBMITTED ON RECYCLED PAPER**

RECEIVED  
CLERK'S OFFICE

OCT 01 2003

BEFORE THE ILLINOIS POLLUTION CONTROL BOARD

STATE OF ILLINOIS  
Pollution Control Board

Quality Pork L.L.C.  
(Property Identification Number  
24-05-300-004)

)  
)  
)  
)

PCB ~~03~~-04-41  
(Tax Certification) -

RECOMMENDATION

The Illinois Environmental Protection Agency ("Illinois EPA") hereby files its Recommendation regarding the tax certification of water pollution control facilities pursuant to pursuant to Section 125.204 of the regulations of the Illinois Pollution Control Board, 35 Ill. Adm. Code 125.204.

1. On December 20, 2002, the Illinois EPA received a request from Quality Pork L.L.C. (Ogle County) (log number TC 18-02, Exhibit A) for an Illinois EPA recommendation regarding the tax certification of water pollution control facilities, pursuant to 35 Ill. Adm. Code 125.204.
2. The applicant's address is: Kim Huntley  
5173 Bend Road  
Chana Illinois 61015
3. The proposed water pollution control facilities in this request are located at Section 5, T40N, Range 1E of the 3rd Principal Meridian, Ogle County at 10339 East Gristmill, Rochelle and consist of the following:

Livestock waste management facilities consisting of two concrete manure pits (each 52 ft. x 325 ft. x 8 ft.), each pit having eight concrete pump-out boxes (each 6 ft. x 6 ft. x 8 ft.) and the slotted portion of the floor over the manure pit in two swine production buildings

These livestock waste facilities are used to collect, transport, and/or store livestock waste prior to cropland application and are further described in Exhibit A.

THIS FILING IS SUBMITTED ON RECYCLED PAPER

4. Section 11-10 of the Property Tax Code, 35 ILCS 200/11-10 (2000), defines "pollution control facilities" as:

"any system, method, construction, device or appliance appurtenant thereto or any portion of any building or equipment, that is designed, constructed, installed or operated for the primary purpose of: (a) eliminating, preventing, or reducing air or water pollution ...or (b) treating, pretreating, modifying or disposing of any potential solid, liquid or gaseous pollutant which if released without treatment, pretreatment modification or disposal might be harmful, detrimental or offensive to human, plant or animal life, or to property."

5. Pollution control facilities are entitled to preferential tax treatment, 35 ILCS 200/11-5.
6. Based on the information in the application and the purpose of the facilities, it is the Illinois EPA's engineering judgment that the described facilities may be considered "pollution control facilities," pursuant to 35 Ill. Adm. Code 125.200(a), with the primary purpose of eliminating, preventing, or reducing water pollution, or as otherwise provided in 35 Ill. Adm. Code 125.200, and are eligible for tax certification from the Board.

WHEREFORE, the Illinois EPA recommends that the Board **issue** the requested tax certification.

ILLINOIS ENVIRONMENTAL PROTECTION AGENCY

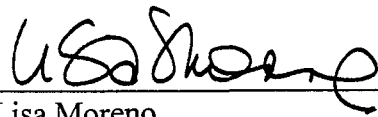
By:   
Lisa Moreno  
Assistant Counsel  
Division of Legal Counsel

DATED: September 29, 2003

Illinois Environmental Protection Agency  
1021 North Grand Avenue East  
Post Office Box 19276  
Springfield, Illinois 62794-9276  
(217) 782-5544

**THIS FILING IS SUBMITTED ON RECYCLED PAPER**

APPLICATION FOR CERTIFICATION (PROPERTY TAX TREATMENT)  
POLLUTION CONTROL FACILITY  
AIR ☐ WATER ☒

ILLINOIS ENVIRONMENTAL PROTECTION AGENCY  
P. O. Box 19276, Springfield, IL 62794-9276

This Agency is authorized to request this information under Illinois Revised Statutes, 1979, Chapter, 120, Section 502a-5. Disclosure of this information is voluntary. However, failure to comply could prevent your application from being processed or could result in denial of your application for certification.

FOR AGENCY USE			
File No.	Date Received	Certification No.	Date
Sec. A  APPLICANT	Company Name <b>Quality Pork LLC</b>		
	Person Authorized to Receive Certification <b>Kim Huntley</b>		Person to Contact for Additional Details <b>Kim Huntley</b>
	Street Address <b>5173 Bend Rd</b>		Street Address <b>5173 Bend Rd</b>
	Municipality, State & Zip Code <b>Chana, IL 61015</b>		Municipality, State & Zip Code <b>Chana, IL 61015</b>
	Telephone Number <b>815 562 6897</b>		Telephone Number <b>815 751 7426</b>
	Location of Facility Quarter Section <b>SW 1/4 5</b>	Township <b>HON</b>	Range <b>1 E</b>
	Municipality <b>Rochelle</b>		Township <b>Flag</b>
	Street Address <b>10339 E. Gristmill</b>		County <b>OGLE</b>
	Property Identification Number		Book Number <b>24-05-300-004</b>
	Sec. B  MANUFACTURING OPERATIONS	Nature of Operations Conducted at the Above Location <b>Swine livestock waste to below Ground Pit</b>	
Water Pollution Control Construction Permit No.		Date Issued	
NPDES PERMIT No.		Date Issued Expiration Date	
Air Pollution Control Construction Permit No.		Date Issued	
Air Pollution Control Operating Permit No.		Date Issued	
Sec. C  MANUFACTURING PROCESS	Describe Unit Process  <b>RECEIVED RECEIVED</b> <b>DEC 20 2002 DEC 20 2002</b>		
	Materials Used in Process  <b>ILLINOIS ENVIRONMENTAL PROTECTION AGENCY</b> <b>BOW/WPC/PERMIT SECTION</b> <b>Surface Water Section</b> <b>BUREAU OF WATER</b>		
Sec. D  POLLUTION CONTROL FACILITY DESCRIPTION	Describe Pollution Abatement Control Facility  <b>Swine confinement pit for livestock waste. Building sits directly over Livestock waste pit.</b> <b>Example 1 + 2 in instructions</b> <b>point of Reference only</b>		

Exhibit A

Sec. E	(1) Nature of Contaminants or Pollutants			
	Material Retained, Captured or Recovered			
	Contaminant or Pollutant	DESCRIPTION	DISPOSAL OR USE	
	Swine effluent	Swine Manure	Cropland Fertilizer	
	(2) Point(s) of Waste Water Discharge			
POLLUTION CONTROL FACILITY - CONTAMINANTS	Plans and Specifications Attached		Yes	No
	(3)	Are contaminants (or residues) collected by the control facility?	Yes <input checked="" type="checkbox"/>	No <input checked="" type="checkbox"/>
	(4)	Date installation completed <u>2-1-02</u> status of installation on date of application <u>Finished</u>		
	(5)	a. FAIR CASH VALUE IF CONSIDERED REAL PROPERTY:	\$	230,000
		b. NET SALVAGE VALUE IF CONSIDERED REAL PROPERTY:	\$	0
		c. PRODUCTIVE GROSS ANNUAL INCOME OF CONTROL FACILITY:	\$	0
		d. PRODUCTIVE NET ANNUAL INCOME OF CONTROL FACILITY:	\$	0
		e. PERCENTAGE CONTROL FACILITY BEARS TO WHOLE FACILITY VALUE:	%	38%

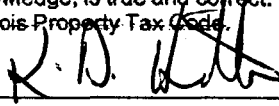
Sec. F	The following information is submitted in accordance with the Illinois Property Tax Code, as amended, and to the best of my knowledge, is true and correct. The facilities claimed herein are "pollution control facilities" as defined in Section 11-10 of the Illinois Property Tax Code.		
	Signature	Title	
		Managing Partner	

Sec. G	INSTRUCTIONS FOR COMPILING AND FILING APPLICATION			
	General: Separate applications must be completed for each control facility claimed. Do not mix types (water and air). Where both air and water operations are related, file two applications. If attachments are needed, record them consecutively on an index sheet.			
	Sec. A	Information refers to applicant as listed in the tax records and the person to be contacted for further details or for inspection of facilities. Define facility location by street address or legal description. A plat map location is required for facilities located outside of municipal boundaries. The property identification number is required.		
	Sec. B	Self-explanatory. Submit copies of all permits issued by local pollution control agencies. (e.g. MSD Construction Permit)		
	Sec. C	Refers to manufacturing processes or materials on which pollution control facility is used.		
	Sec. D	Narrative description of the pollution control facility, indicating that its primary purpose is to eliminate, prevent or reduce pollution. State the type of control facility. State permit number, date, and agency issuing permit. A narrative description and a process flow diagram describing the pollution control facility. Include a listing of each major piece of equipment included in the claimed fair cash value for real property. Include an average analysis of the influent and effluent of the control facility stating the collection efficiency.		
	Sec. E	List air contaminants, or water pollution substances released as effluents to the manufacturing processes. List also the final disposal of any contaminants removed from the manufacturing processes. Item (1) - Refers to pollutants and contaminants removed from the process by the pollution control facility. Item (2) - Refers to water pollution but can apply to water-carried wastes from air pollution control facilities. Submit drawings, which clearly show (a) Point(s) of discharge to receiving stream, and (b) Sewers and process piping to and from the control facility. Item (3) - If the collected contaminants are disposed of other than as wastes, state the disposition of the materials, and the value in dollars reclaimed by sale or reuse of the collected substances. State the cost of reclamation and related expense. Item (4) - State the date which the pollution control facility was first placed in service and operated. If not, explain. Item (5) - This information is essential to the certification and assessment actions. This accounting data must be completed to activate project review prior to certification by this Agency.		
	Sec. F	Self-explanatory. Signature must be a corporate authorized signature.		
		Submit to:	Attention:	Attention:
		Illinois EPA P.O. Box 19276 Springfield, IL 62794-9276	Thomas McSwiggin Permit Section Division of Water Pollution Control	Donald E. Sutton Permit Section Division of Air Pollution Control

RECEIVED

DEC 20 2002

Tax Certification for Pollution Control Facilities

Page 2 of 2  
8/00

Surface Water Section  
BUREAU OF WATER

# Section D

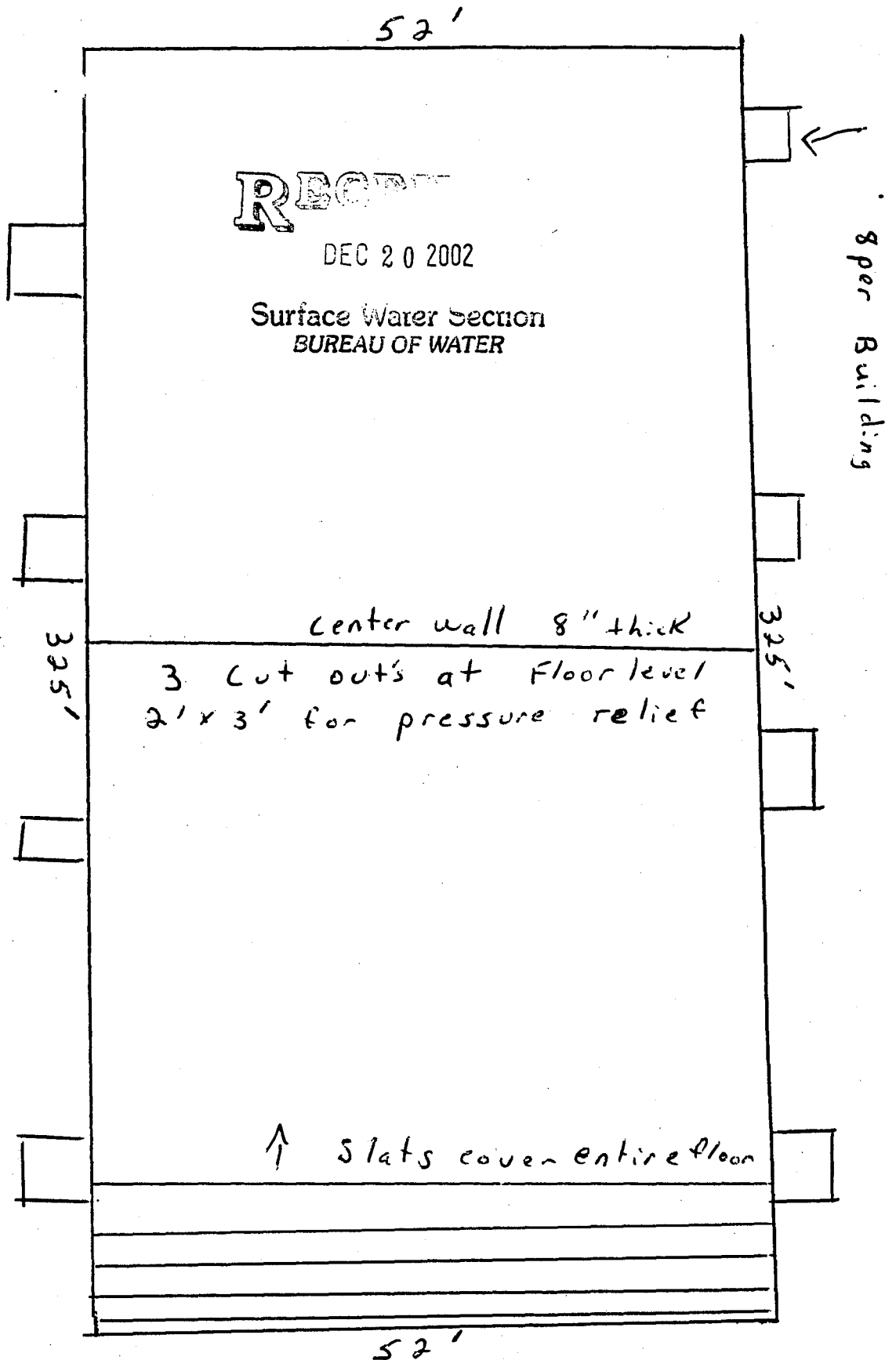

- Floor: 4" thick steel mesh in floor walls & support: 8" thick w/ rebar on 12" centers
- 2 Barns on site exactly the same 52' x 325' x 8'
- Slats: 4' x 10' w 4" Broom
- Barn fully slatted over top of Pit

Quality Park LLC

# Section D

REC  
DEC 20 2002

Surface Water Section  
BUREAU OF WATER

Quality Pork LLC

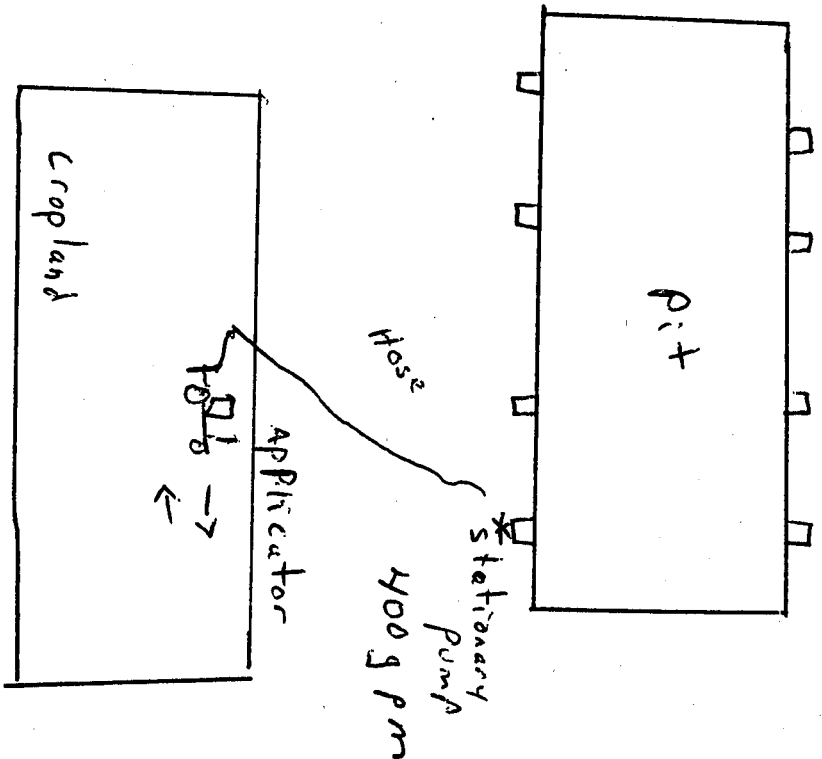
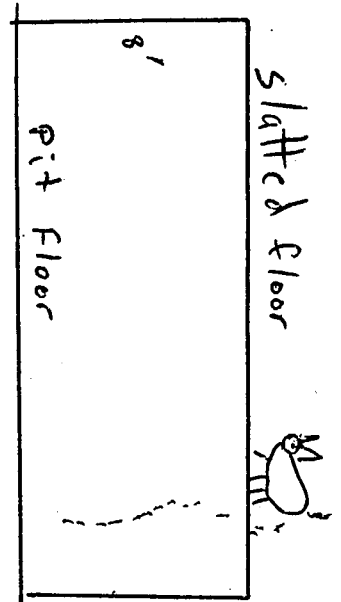

manure is injected at  
a depth of 6",

Manure is tested and applied  
according to crop removal of  
nutrients

manure is held in pit until  
it is pumped to cropland  
current holding capacity is in  
excess of 1 year



STATE OF ILLINOIS

COUNTY OF SANGAMON

)  
)  
)  
)  
)

**PROOF OF SERVICE**

I, the undersigned, on oath state that I have served the attached **APPEARANCE AND THE RECOMMENDATION**, upon the person to whom it is directed, by placing a copy in an envelope addressed to:

Dorothy M. Gunn, Clerk  
Illinois Pollution Control Board  
James R. Thompson Center  
100 West Randolph Street, Suite. 11-500  
Chicago, Illinois 60601

Kim Huntley  
5173 Bend Road  
Chana Illinois 61015

Steve Santarelli  
Illinois Department of Revenue  
101 West Jefferson  
Post Office Box 19033  
Springfield, Illinois 62794

and mailing it from Springfield, Illinois on September 29, 2003 with sufficient postage affixed for first class mail.

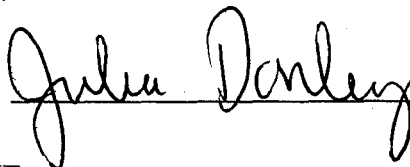

SUBSCRIBED AND SWORN TO BEFORE ME

this 29<sup>th</sup> day of September, 2003.

  
Notary Public



**THIS FILING IS SUBMITTED ON RECYCLED PAPER**